

Typical Keyhole Garden

A design strategy for increasing yields & using less energy & resources.

May have a Weed Barrier here
*comprising of Comfrey &
Arrowroot, Cassava, Pigeon
Pea, Crotalaria Luceane,
Paw Paw, Banana etc.*

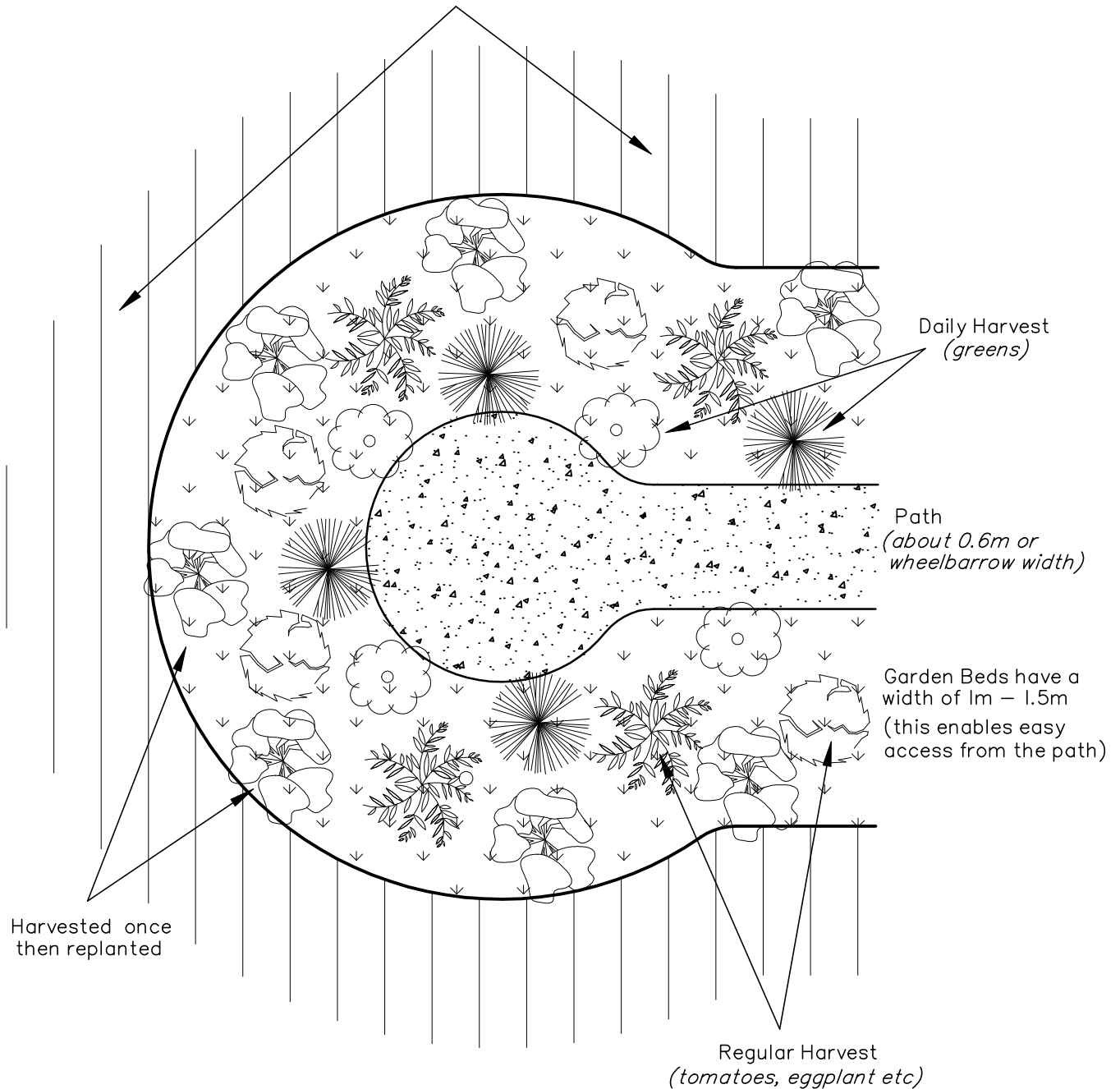

Plants are strategically placed
*The more often a particular type
of plant is harvested the closer
it is placed to the path.*
*This helps to keep trampling of
the garden bed to a minimum.*